



↻ 355° ↻ 30°

LED DOWNLIGHT

ANUP-DL122

Introduction



Antipodes ANUP-DL122 is a led COB downlight with interchangeable reflector design, 3 different beam angle reflectors for optional. Adjustable lighting direction design can meet various demands.

Triac dimmable version achieves great dimming compatibility with worldwide brand dimmers. Aluminium profile provides excellent thermal dissipation.

Features

1. Unique and stylish design.
2. CITIZEN COB led with high lumen output.
3. Rotatory angle 355° in horizontal and 30° in vertical.
4. Aluminium fixture with excellent thermal dissipation.
5. Interchangeable reflector design: 24° / 45° / 60° beam angle reflectors for optional.
6. External driver

Application Areas

It is designed for general lighting applications in office, supermarket, shop, school, hotel, etc. It is also widely used for public areas, such as stairway, lobby, reception, corridors etc.

↻ 355° ↕ 30°



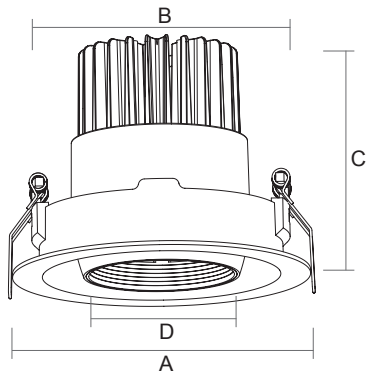

Measurement

Inch	Dimension(mm)				Size(mm)	Product Weight (Kg)		Package weight (Kg)	
	A	B	C	D		N.W/PC	G.W/PC	N.W/CTN	G.W/CTN
4"	150	130	116	75	Ø150x116	0.71	0.875	10.5	12
6"	185	155	130	100	Ø185x130	1.1	1.3	15.6	17.5

Technical Data Sheet

Model No.	ANUP-DL122-4-18W	ANUP-DL122-4-25W	ANUP-DL122-6-25W	ANUP-DL122-6-35W	ANUP-DL122-6-42W	
Watt(W)	18W	25W	25W	35W	42W	
Dimension(mm)	Ø150x116	Ø150x116	Ø185x130	Ø185x130	Ø185x130	
Cutout (mm)	Ø130-140	Ø130-140	Ø160-170	Ø160-170	Ø160-170	
Rated Input Voltage(V)	AC230V					
Input Voltage(V)	AC200-240V AC220-240V					
LED	COB					
SDCM	<6					
CCT(K)	2700K / 3000K / 4000K / 5000K					
"Luminous Flux (lm) ±5%"	Non-DIM	1650-1820	2200-2430	2250-2420	3030-3260	3230-3780
	DIM	1620-1800	2190-2400	2220-2400	2980-3230	3150-3720
CRI	≥80					
Beam Angle (°)	24° / 45° / 60°					
LED Driver	Built-out					
DIM	Triac					
Protection Class	Class II					
IP Rating	IP20					
IK Rating	-					
Finishing color	White RAL 9016					
Material	Aluminium + PC					
Lifetime (hr)	50,000h					
Glow wire test (°C)	850°C					
Operating Temp.(°C)	-20°C ~45°C					
Storage Temp.(°C)	-20°C ~65°C					
Installation	Recessed					
Brand Driver option	-					

Driver Datasheet (Non-dimmable)

Power	18W	25W	35W	42W
Rated Input Voltage(V)	AC230V			
Frequency	50/60Hz			
Input Voltage	AC220-240V			
Power Factor	0.9			
Efficiency	≥84%	≥85%	≥85%	≥85%
Total load wattage	18W±1W	25W±5%	35W±5%	42W±5%
Rated Input Current	≤0.1A	≤0.13A	≤0.19A	≤0.22A
Full load output voltage	DC28-40V	DC28-40V	DC28-40V	DC28-40V
Rated output current	450mA	650mA	850mA	1000mA
Output current range	450mA±5%	650mA±5%	850mA±5%	1000mA±5%
Power tolerance	5%			
Current output tolerance	5%			
Short circuit protection	PASS			
Over voltage protection	PASS			
Over temperature protection	PASS			
THD	≤20% @230V			
Surge	L-N 500V		L-N 1KV	
Withstand voltage	AC3750V			

Driver Datasheet (Triac Dimmable)

Power	18W	25W	35W	42W
Rated Input Voltage(V)	AC230V			
Frequency	50Hz			
Input Voltage	AC200-240V			
Power Factor	0.9			
Efficiency	83%	85%	85%	85%
Total load wattage	18W±1W	25W±5%	35W±5%	42W±5%
Rated Input Current	≤0.1A	≤0.14A	≤0.2A	≤0.25A
Full load output voltage	DC23-40V	DC23-40V	DC23-40V	DC23-40V
Rated output current	430mA	600mA	800mA	1000mA
Output current range	430mA±5%	600mA±5%	800mA±5%	1000mA±5%
Power tolerance	±5%			
Current output tolerance	±5%			
Dimming Range	8%-100%			
Short circuit protection	PASS			
Over voltage protection	PASS			
Over temperature protection	PASS			
THD	≤20% @230V			
Surge	L-N 500V			
Withstand voltage	AC3750V			

Note: DALI & 0-10V driver specification, please refer to individual driver datasheet.

How to change the reflector

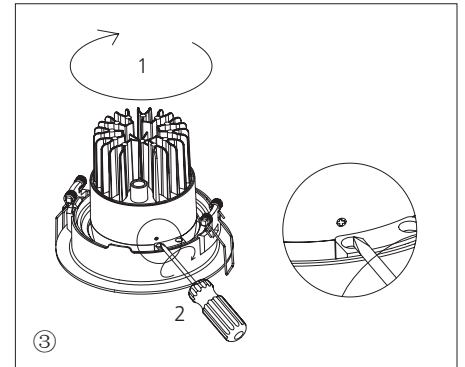
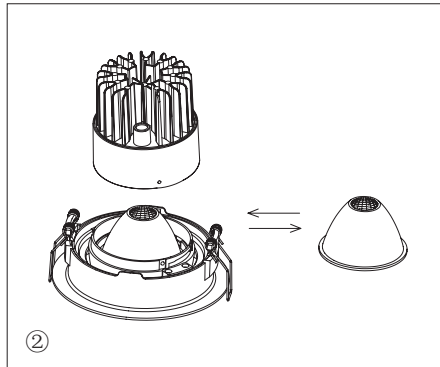
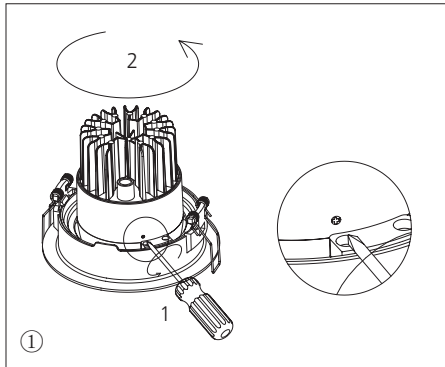

Installation Procedure

WARNING ⚡

1. Switch off before installation.
2. Switch on only after complete installation and examination of the circuit.
3. Professional electrician for installation and maintenance only.

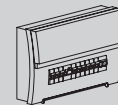

Turn Off
Power Supply

Turn Off power supply before starting any installation. Read instructions & check you have all the tools & accessories to complete the installation correctly.

■ Recessed Installation Only

Step 1

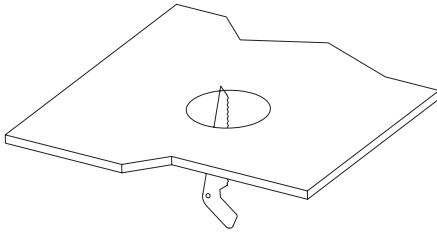

Open a hole according to the cutout size of led downlight.

Step 2

Use screw-driver to open the driver terminal cover, feed the main AC wire L. N. in terminal block respectively, then fix the cover back.

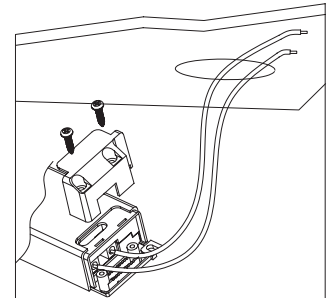

Step 3

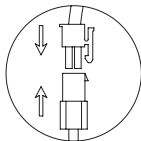

Connect the downlight with driver, hold back the spring clip then push the downlight into the hole.

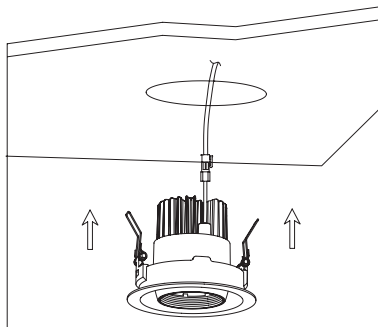

Step 4

Make sure the downlight fixed tightly in ceiling, turn on the power.

